

Pb Free Thermal Cutoffs

ELCUT 22 Series



The photo of 22JR is shown.

FEATURES

- The environment-friendly products do not contain cadmium and lead.

IMPORTANT NOTICE

Read Standard Specification and Instruction Manual for use throughly.

TERMS

- Rated Functioning Temperature (T_f)**
The acceptable tolerance is +0, -10°C except PSE. The one for PSE is ±7°C.
- Holding Temperature (C-UL & CSA: T_h, CCC: T_c)**
The highest temperature of the thermal cutoff at which it will not open the circuit for 168 hours while passing rated current. (Applicable to CSA, C-UL and CCC)
- Maximum Temperature Limit (T_m)**
The highest temperature at which continuity does not occur for 10 minutes after the fusing off of the thermal cutoff.

Ratings

Type No.	Rated Functioning Temperature T _f (°C)	Cut-off Temperature (°C)	T _h T _c (°C)	Max. Use Temp.* ₂ (°C)	T _m (°C)	Electrical Rating		UL	C-UL (CSA) * ₁	VDE	CCC	PSE
						Ampere (A)	Voltage (V)					
22ER	108	104±3	89	81	200	4	AC250					
			87	79		5	AC125			-		
222R	115	112±3	92	89	200	5	AC250		* ₁			
			83	83		7	AC125		* ₁		-	
22MR	139	135±3	122	114	200	2.5	AC250					
			95	57		14	DC50			-	-	
22JR	145	141±3	125	115	200	3.5	AC250					
			113	90		7	AC125					

UL,C-UL:E50082, CSA: LR40743, VDE:923000-1171-0002
*₁: Certified by CSA *₂: Maximum allowable normal use temperature

Cut-off temperature is measured with silicone oil bath of which temperature is increased at the rate of 1°C /min. Detecting current is 0.1A or less.

T_h and T_c are for C-UL(CSA) and CCC respectively.

Dimensions

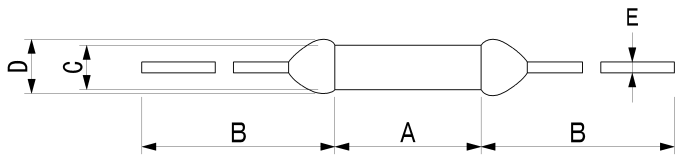

Dimensions (mm)					
Lead length	A	B	C	D	E
Regular	11.5±0.5	37±3	3.3±0.2	3.6 or below	1.0±0.05
Long		67±3			

Uchihashi Estec Co.,Ltd.

Headquarters/Overseas Sales Section
9-14, Imazu-Kita 2-chome, Tsurumi-ku, Osaka 538-0041 Japan
TEL (06)6962-6666(INT-81-6-6962-6666)
FAX (06)6962-6668(INT-81-6-6962-6668)

<http://www.uchihashi.co.jp/english/>