

Pb Free Thermal Cutoffs

ELCUT U2 Series

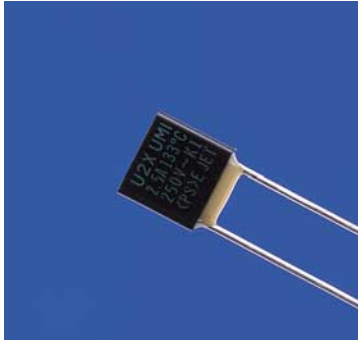

The photo of U2X is shown.

FEATURES

- The environment-friendly products do not contain cadmium and lead.

IMPORTANT NOTICE

Read Standard Specification and Instruction Manual for use throughly.

TERMS

- Rated Functioning Temperature (Tf)**
The acceptable tolerance is +0, -10°C except PSE. The one for PSE is ±7°C.
- Holding Temperature**
(C-UL & CSA: Th, CCC: Tc)
The highest temperature of the thermal cutoff at which it will not open the circuit for 168 hours while passing rated current. (Applicable to CSA, C-UL and CCC)
- Maximum Temperature Limit (Tm)**
The highest temperature at which continuity does not occur for 10 minutes after the fusing off of the thermal cutoff.

Ratings

Type No.	Rated Functioning Temperature Tf(°C)	Cut-off Temperature (°C)	Th (°C)	Tc (°C)	Max. Use Temp.*2 (°C)	Tm (°C)	Electrical Rating		UL	C-UL (CSA) *1	VDE	CCC	PSE
							Ampere (A)	Voltage (V)					
U2E	108	104±3	88	81	200	2	AC250						
U22	115	112±3	89	89	200	2.5	AC250		*1				
U2X	133	129±3	112	102	200	2.5	AC250						
U2J	145	141±3	120	115	200	2.5	AC250						
			92	87		5	AC125				-	-	

UL,C-UL:E50082, CSA: LR57404, VDE:923000-1171-0011
 *1: Certified by CSA *2: Maximum allowable normal use temperature

Cut-off temperature is measured with silicone oil bath of which temperature is increased at the rate of 1°C /min. Detecting current is 0.1A or less.

Th and Tc are for C-UL(CSA) and CCC respectively.

Dimensions

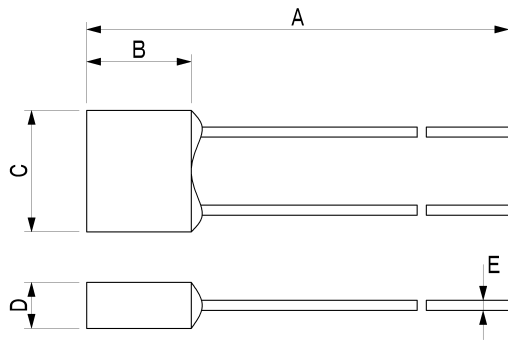

Dimensions (mm)					
Lead length	A	B	C	D	E
Regular	55±3	5.7±0.5	6.6±0.5	2.5±0.3	0.53±0.02
Long	70±3				

Uchihashi Estec Co.,Ltd.

Headquarters/Overseas Sales Section
 9-14, Imazu-Kita 2-chome, Tsurumi-ku, Osaka 538-0041 Japan
 TEL (06)6962-6666(INT-81-6-6962-6666)
 FAX (06)6962-6668(INT-81-6-6962-6668)

<http://www.uchihashi.co.jp/english/>