

COMPACT POWER RELAY

For automotive applications

1 POLE-25A (for 12V car battery)

FTR-P3 Series

■ FEATURES

- Compact for high density packaging
 - High contact capacity with proven contact material.
(100,000 operations, 14 V, 25 A)
 - Coil power savings (600mW nominal achieved with state-of-the-art magnetic design)
 - Ease of PCB layout (all terminals on perimeter, coil and contact terminals separated)
 - Optional over-voltage circuit breaking capability
(0.6mm gap, contact our representative)
 - Packaging for auto-insertion (tube packing, 30 relays/tube)
 - Application examples: power window, power seat, tilt steering, sunroof, wiper, retractable antenna, etc.
 - Reflowable & high stand-off type available.
 - RoHS compliant
- Please see page 7 for more information



■ PARTNUMBER INFORMATION

[Example] FTR-P3 C N 012 W1 -06
 (a) (b) (c) (d) (e) (f)

(a)	Relay type	FTR-P3	: FTR-P3 Series
(b)	Contact configuration	A	: 1 form A (only with -06)
		C	: 1 form C
(c)	Contact gap	N	: 0.25mm gap
		P	: 0.6mm gap (standard and -ML)
(d)	Coil rated voltage	012	: 9.....12VDC Coil rating table at page 3
(e)	Contact material	W1	: Silver-tin oxide indium
(f)	Special type	None	: Standard
		-ML	: Multi-layered contacts
		-06	: High stand-off (Reflowable type)

Actual marking does not carry the type name: "FTR (-ML) (-06)"

E.g.: Ordering code: FTR-P3CN012W1-06

Actual marking: P3CN012W1

FTR-P3 SERIES

■ SPECIFICATION

Item	FTR-P3			
		Standard (without suffix)	Multi layered con- tact (-ML)	Reflowable (-06)
Contact Data	Configuration	1 form C (SPDT)		1 form A (SPST) 1 form C (SPDT)
	Material	Silver-tin oxide indium		
	Contact path voltage drop	Max. 100mV at 1A, 12VDC		
	Contact rating	25A at 14VDC (locked motor load)		
	Max. carrying current * ¹	25A/1 hour (25 °C, 100% rated coil voltage)		
	Max. switching voltage	16VDC (reference)		
	Max. switching current	35A (reference)		
	Min. switching load * ²	6VDC, 1A (reference)		
Life	Mechanical	Min. 10 x 10 ⁶ operations	Min. 1 x 10 ⁶ operations	
	Electrical	Min. 100 x 10 ³ operations, 14VDC, 25A (locked motor load) (1 operation = 1 forward and 1 reverse)		
Coil data	Operating ambient temperature range	-40 °C to +85 °C (no frost)		-40 °C to +125 °C (no frost)
	Storage temperature range (no frost)	-40 °C to +85 °C, 45 ~ 85% RH	-40 °C to +100 °C, 45 ~ 85% RH	-40 °C to +125 °C, 45 ~ 85% RH
Timing Data	Operate (at nominal voltage)	Max. 10 ms (without bounce)		
	Release (at nominal voltage)	Max. 5 ms (without bounce, no diode) Max. 15 ms (without bounce, with diode)		
Insulation	Resistance (initial)	100M Ω at 500VAC		
	Dielectric withstanding voltage (initial)	500VAC, 1 minute		
Other	Vibration resistance	Misoperation	10 to 200Hz, acceleration 43m/s ² (4.4G), constant acceleration	
		Endurance	10 to 200Hz, acceleration 43m/s ² (4.4G), constant acceleration	
	Shock	Misoperation	100m/s ² minimum (11+/-1ms)	
		Endurance	1,000m/s ² minimum (6+/-1ms)	
	Weight	Approximately 5 g		

* 1 Need to consider the heat from PCB when max. current is more than 10A.

* 2 Minimum switching loads mentioned above are reference values. Please perform the confirmation test with actual load before production since reference values may vary according to switching frequencies, environmental conditions and expected reliability levels.

■ COIL RATING

FTR-P3 Series (0.25mm contact gap) (Standard, multi layered contact)

Coil Code	Rated Coil Voltage (VDC)	Coil Resistance +/- 10% (Ohm)	Must Operate Voltage (VDC) *	Must Release Voltage (VDC) *
009	9	135	5.5 (at 20 °C)	0.7 (at 20 °C)
			6.9 (at 85 °C)	0.9 (at 85 °C)
010	10	167	6.3 (at 20 °C)	0.8 (at 20 °C)
			7.9 (at 85 °C)	1.0 (at 85 °C)
012	12	240	7.3 (at 20 °C)	1.0 (at 20 °C)
			9.2 (at 85 °C)	1.3 (at 85 °C)

FTR-P3-06 Series

Coil Code	Rated Coil Voltage (VDC)	Coil Resistance +/- 10% (Ohm)	Must Operate Voltage (VDC) *	Must Release Voltage (VDC) *
009	9	135	5.5 (at 20 °C)	0.7 (at 20 °C)
			6.9 (at 85 °C)	0.9 (at 85 °C)
			7.8 (at 125 °C)	1.0 (at 125 °C)
010	10	167	6.3 (at 20 °C)	0.8 (at 20 °C)
			7.9 (at 85 °C)	1.0 (at 85 °C)
			8.9 (at 125 °C)	1.1 (at 125 °C)
012	12	240	7.3 (at 20 °C)	1.0 (at 20 °C)
			9.2 (at 85 °C)	1.3 (at 85 °C)
			10.3 (at 125 °C)	1.4 (at 125 °C)

FTR-P3 Series (0.6mm contact gap) (Standard, multi layered contact)

Coil Code	Rated Coil Voltage (VDC)	Coil Resistance +/- 10% (Ohm)	Must Operate Voltage (VDC) *	Must Release Voltage (VDC) *
009	9	100	5.5 (at 20 °C)	0.7 (at 20 °C)
			6.9 (at 85 °C)	0.9 (at 85 °C)
010	10	125	6.3 (at 20 °C)	0.8 (at 20 °C)
			7.9 (at 85 °C)	1.0 (at 85 °C)
012	12	167	7.3 (at 20 °C)	1.0 (at 20 °C)
			9.2 (at 85 °C)	1.3 (at 85 °C)

Note: All values in the tables are valid for 20°C and zero contact current, unless otherwise stated. Must operate voltages/must release voltages at 125degC are available only for reflowable type. * Specified operate values are valid for pulse wave voltage.

CHARACTERISTIC DATA

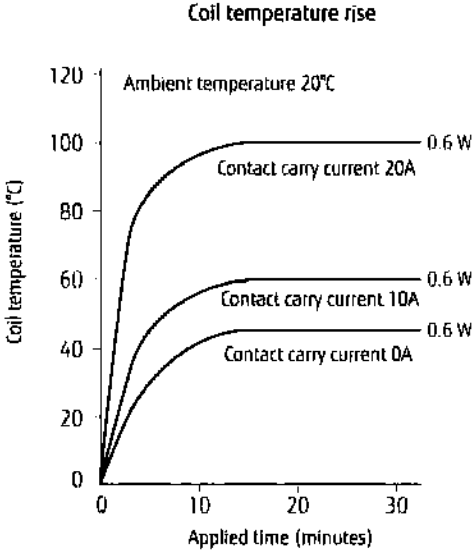
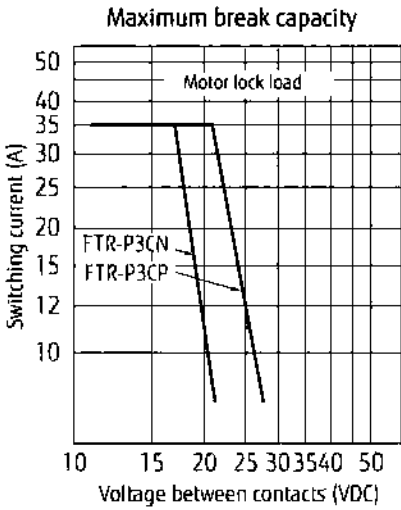

Life test (examples)

Test condition
 25A, 14VDC
 motor lock
 100,000 operations min.
 0.25 seconds ON
 9.75 seconds OFF

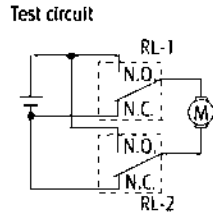

Current wave form

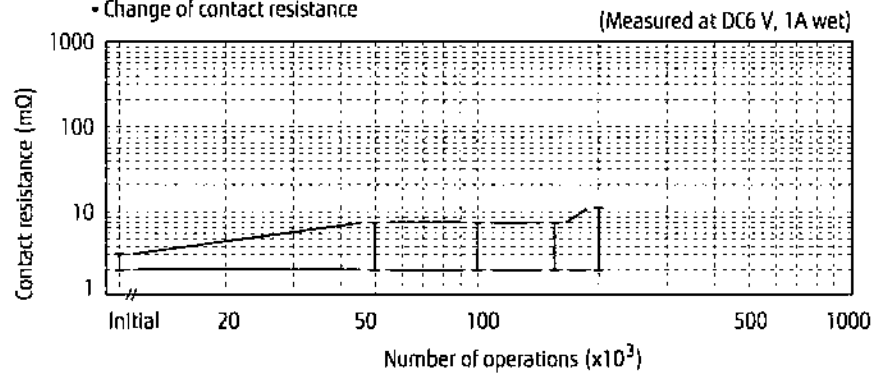
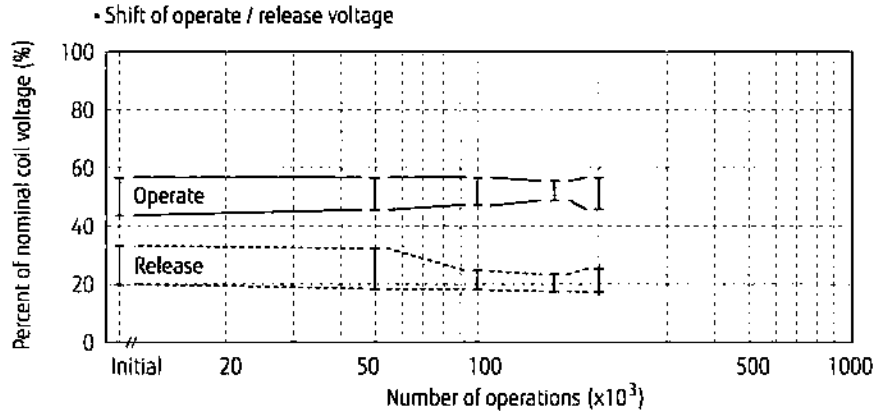
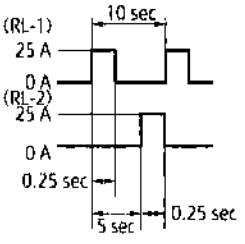

FTR-P3 SERIES

Test condition
 Inrush current 17A, 14VDC
 motor free
 300,000 operations min.
 0.25 seconds ON
 9.75 seconds OFF

Test circuit

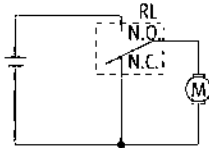

• Shift of operate / release voltage

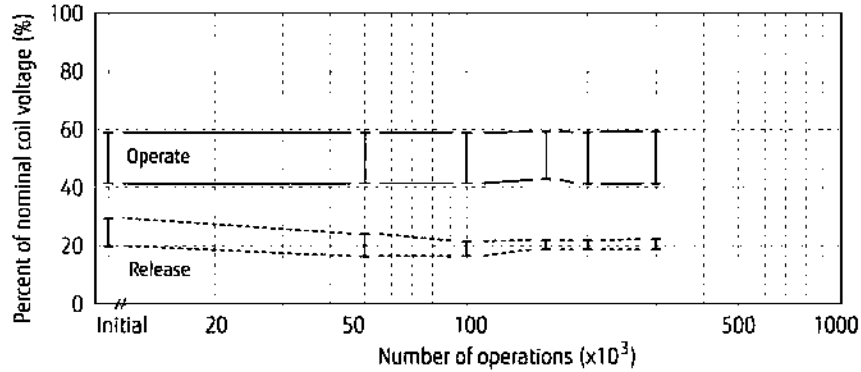

Current wave form

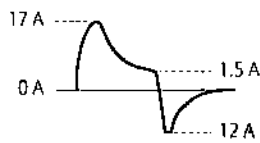

• Change of contact resistance

(Measured at DC6 V, 1A wet)

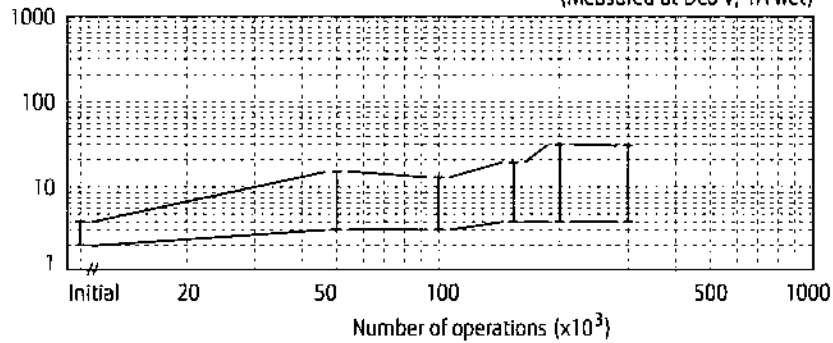

Vibration resistance characteristics
 Dual amplitude (mm)

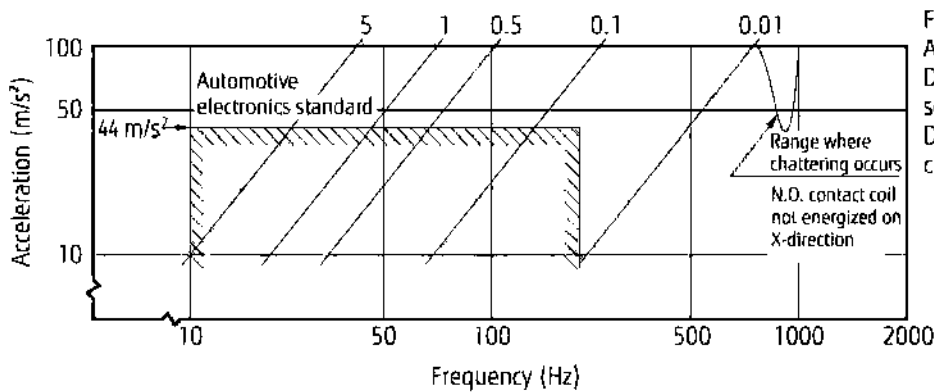

Frequency: 10-2000 Hz
 Acceleration: 100 m/s² max.
 Direction of vibration;
 see diagram below
 Detection level:
 chatter > 1ms

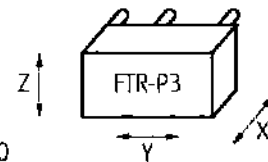

Shock resistance characteristics

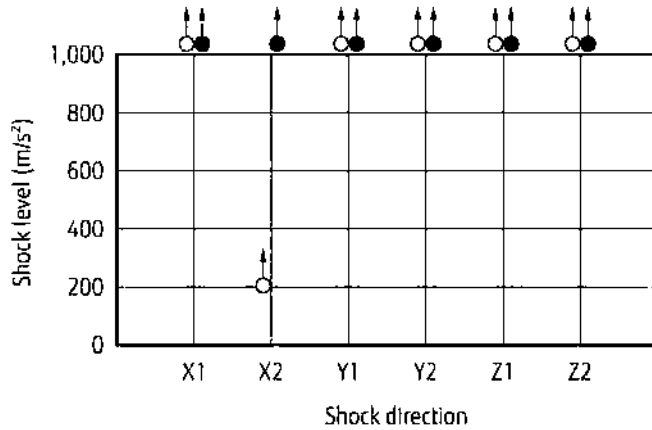

Shock application time: 11±1ms, half-sine wave
 Test material: coil energized and de-energized
 Shock direction: see diagram below
 Detection level: chatter > 1ms

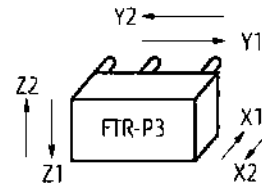

○ : break contact (coil de-energized)
 ● : make contact (coil energized)

Operating coil voltage range (Standard/Multi-layered contacts)

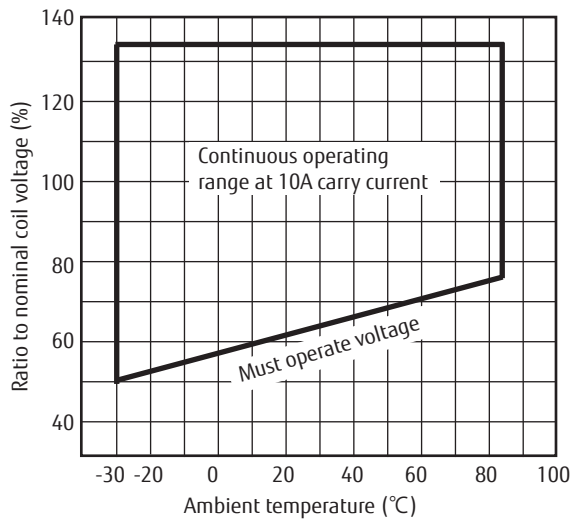

Operating coil voltage range (Reflowable)

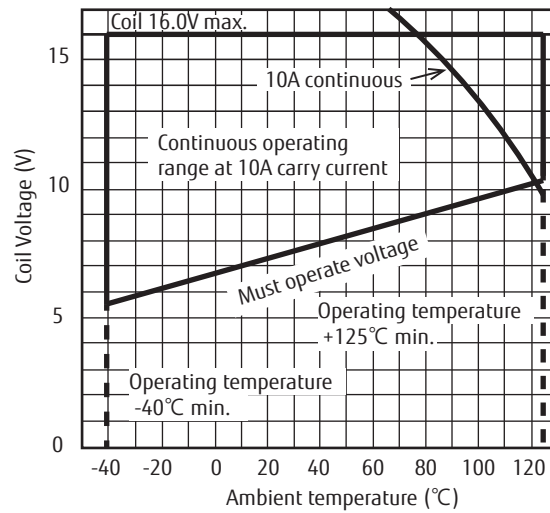

Distribution of operate/release voltage

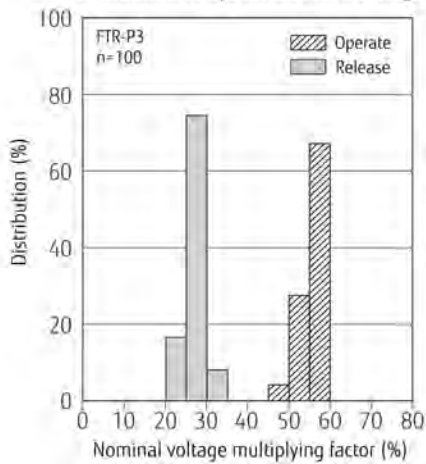

Distribution of operate/release time

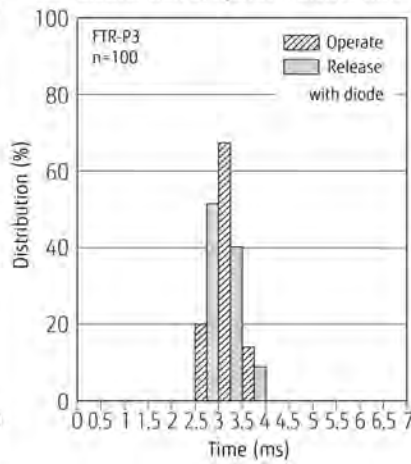

Distribution of contact resistance

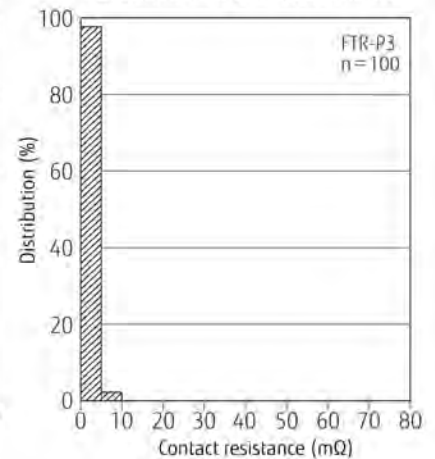

■ DIMENSIONS

Standard multi layered contact

FTR-P3 dimensions

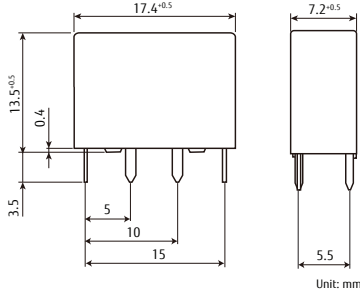

FTR-P3-06 dimensions

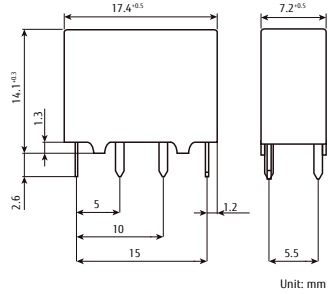

FTR-P3CN***W1 dimensions

FTR-P3CN***W1-06 (1 form C) dimensions

FTR-P3AN***W1-06 (1 form A) dimensions

* Dimensions of the terminals does not include thickness of pre-solder

● Schematics (BOTTOM VIEW)

FTR-P3CN***W1(-ML)

FTR-P3CN***W1-06 (1 form C)

FTR-P3AN***W1-06 (1 form A)

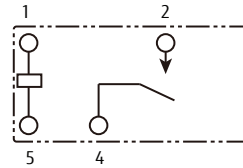
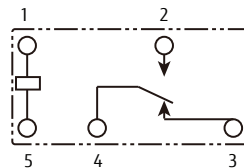
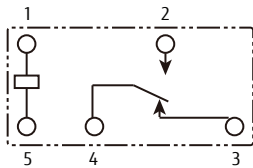

● PC board mounting hole layout (Plated through hole) (BOTTOM VIEW)

FTR-P3CN***W1(-ML)

FTR-P3CN***W1-06 (1 form C)

FTR-P3AN***W1-06 (1 form A)

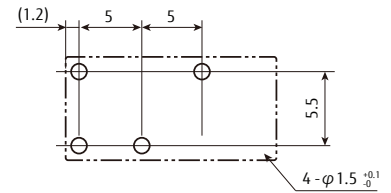
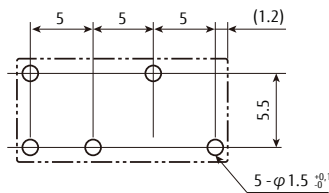
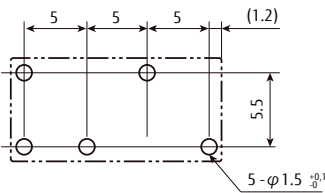

Tolerance: +0.1 / -0 mm unless otherwise specified
unit: mm

General Information

1. RoHS Compliance

- | All relays produced by Fujitsu Components are compliant with RoHS directive 2011/65/EU including amendments.
- | Use of Cadmium in electrical contacts is exempted as per Annex III of the RoHS directive 2001/65/EU. Please consider expiry date of exemption. Relays with Cadmium containing contacts are not to be used for new designs.
- | All relays are lead-free. Please refer to Lead-Free Status Info for older date codes at: <http://www.fujitsu.com/downloads/MICRO/fcai/relays/lead-free-letter.pdf>

2. Recommended Lead Free Solder Condition

- | Lead free solder plating on relay terminals is Sn-3.0Ag-0.5Cu, unless otherwise specified. This material has been verified to be compatible with PbSn assembly process.
- | Recommended solder for assembly: Sn-3.0Ag-0.5Cu.

Flow Solder Condition:

Pre-heating: maximum 120°C within 90 sec.
 Soldering: dip within 5 sec. at 255°C ± 5°C solder bath
 Relay must be cooled by air immediately after soldering

Solder by Soldering Iron:

Soldering Iron 30-60W
 Temperature: maximum 350-360°C
 Duration: maximum 3 sec.

Reflow Solder Condition:

Pre-heating: maximum 170°C within 120 sec.
 Soldering: maximum 250°C within 30 sec.

Note: Please do not reflow non-reflowable relays.

Flow Solder Condition:

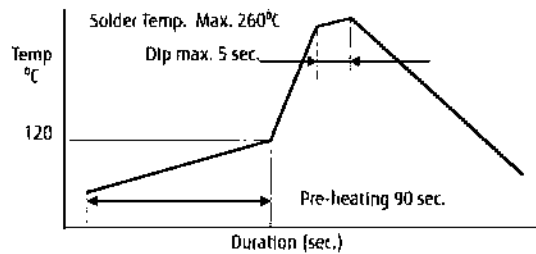

Reflow Solder Condition:

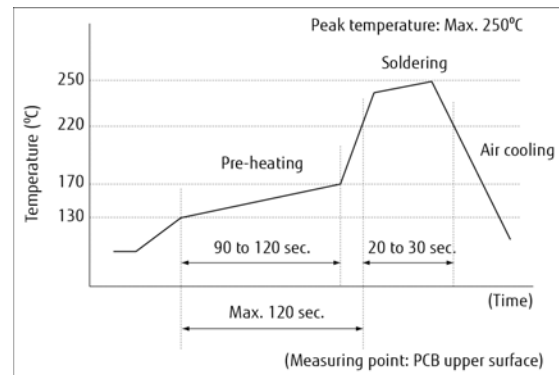

We highly recommend that you confirm your actual solder conditions

3. Moisture Sensitivity

- Moisture Sensitivity Level is not applicable, unless otherwise indicated.

4. Tin Whiskers

- Dipped SnAgCu solder is known as presenting a low risk to tin whisker development. No considerable length whisker was found by our in house test.

Fujitsu Components International Headquarter Offices

Japan FUJITSU COMPONENT LIMITED Shinagawa Seaside Park Tower 19F, 12-4, Higashi-shinagawa 4-chome, Shinagawa-ku, Tokyo, 140-0002, Japan Tel: (81-3) 3450-1682 Fax: (81-3) 3474-2385 Email: fcl-contact@cs.jp.fujitsu.com Web: www.fujitsu.com/jp/fcl/	Asia Pacific FUJITSU COMPONENTS ASIA, LTD. 102E Pasir Panjang Road #01-01 Citilink Warehouse Complex Singapore 118529 Tel: (65) 6375-8560 Fax: (65) 6273-3021 Email: fcal@sg.fujitsu.com Web: www.fujitsu.com/sg/products/devices/components	Korea FUJITSU COMPONENTS KOREA LIMITED Alpha Tower #403, 645 Samsyeong-dong, Bundang-gu, Seongnam-si, Gyeonggi-do, 13524 Korea Tel: (82) 31-708-7108 Fax: (82) 31-709-7108 Email: fcal@sg.fujitsu.com www.fujitsu.com/sg/products/devices/components/
North and South America FUJITSU COMPONENTS AMERICA, INC 2290 North First Street, Suite 212 San Jose, CA 95131, USA Tel: (1-408) 745-4900 Fax: (1-408) 745-4970 Email: components@us.fujitsu.com Web: us.fujitsu.com/components	China FUJITSU ELECTRONIC COMPONENTS (SHANGHAI) CO., LTD. Unit 4306, InterContinental Center 100 Yu Tong Road, Shanghai 200070, China Tel: (86-21) 3253 0998 Fax: (86-21) 3253 0997 Email: fcal@sg.fujitsu.com Web: www.fujitsu.com/sg/products/devices/components	
Europe FUJITSU COMPONENTS EUROPE B.V. Diamantlaan 25 2132 WV Hoofddorp Netherlands Tel: (31-23) 5560910 Fax: (31-23) 5560950 Email: info@fceu.fujitsu.com Web: www.fujitsu.com/uk/components	Hong Kong FUJITSU COMPONENTS HONG KONG CO., LTD Unit 506, Inter-Continental Plaza No.94 Granville Road, Tsim Sha Tsui, Kowloon, Hong Kong Tel: (852) 2881-8495 Tex: (852) 2894-9512 Email: fcal@sg.fujitsu.com Web: www.fujitsu.com/sg/products/devices/components/	

©2016 Fujitsu Components Europe B.V. All rights reserved. All trademarks or registered trademarks are the property of their respective owners.

The contents, data and information in this datasheet are provided by Fujitsu Component Ltd. as a service only to its user and only for general information purposes.

The use of the contents, data and information provided in this datasheet is at the users' own risk.

Fujitsu has assembled this datasheet with care and will endeavor to keep the contents, data and information correct, accurate, comprehensive, complete and up to date.

Fujitsu Components Europe B.V. and affiliated companies do however not accept any responsibility or liability on their behalf, nor on behalf of its employees, for any loss or damage, direct, indirect or consequential, with respect to this datasheet, its contents, data, and information and related graphics and the correctness, reliability, accuracy, comprehensiveness, usefulness, availability and completeness thereof.

Nor do Fujitsu Components Europe B.V. and affiliated companies accept on their behalf, nor on behalf of its employees, any responsibility or liability for any representation or warrant of any kind, express or implied, including warranties of any kind for merchantability or fitness for particular use, with respect to these datasheets, its contents, data, information and related graphics and the correctness, reliability, accuracy, comprehensiveness, usefulness, availability and completeness thereof. Rev. July 20th, 2016